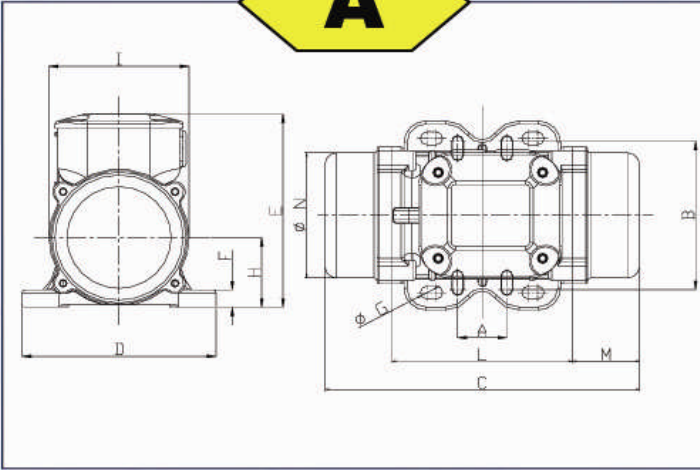
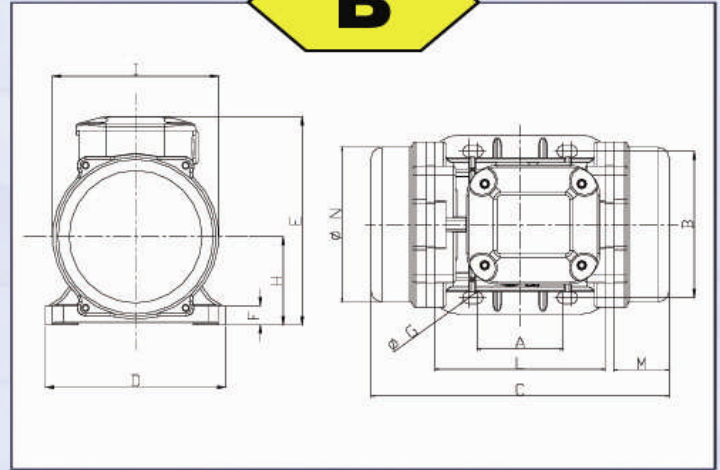
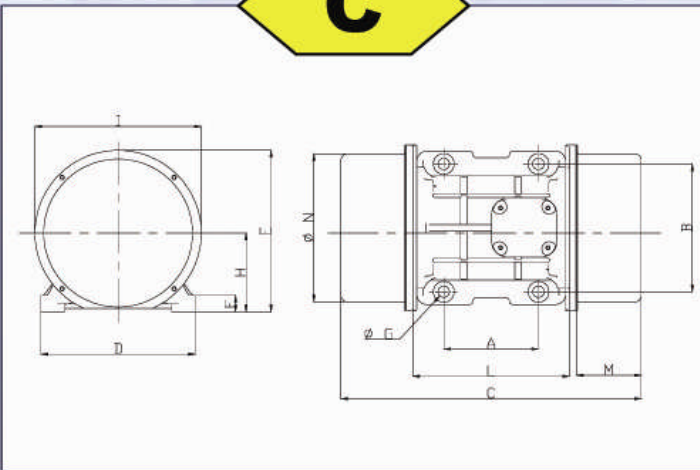
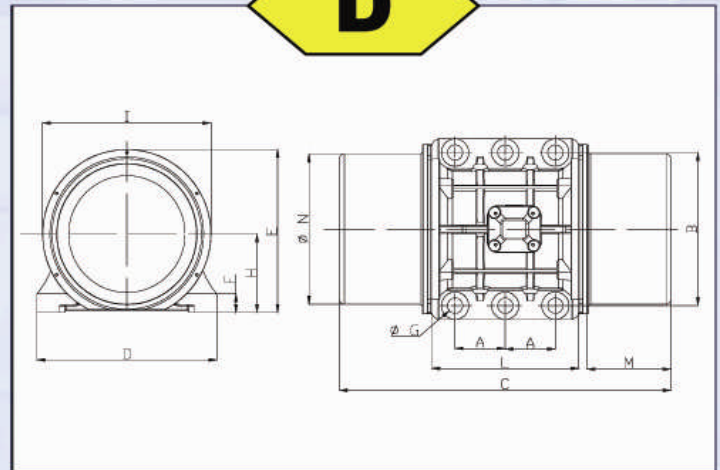

**A****B****C****D**

## Footprint Dimensions

Size	Figure	A		B		Ø G		Strain Relief
		mm	inch	mm	inch	mm	inch	
10	A	62-74	2.44-2.91	106	4.17	9	0.35	M16
		33	1.30	83-102	3.27-4.02	7	0.28	
20	B	62-74	2.44-2.91	106	4.17	9	0.35	M16
30	C	80	3.15	110	4.33	11	0.43	M20
		90	3.54	125	4.92	13	0.51	
		124	4.88	110	4.33	11	0.43	
		135	5.31	115	4.53	11	0.43	
40	C	105	4.13	140	5.51	13	0.51	M20
50	C	120	4.72	170	6.69	17	0.67	M20
60	C	140	5.51	190	7.48	17	0.67	M25
70	C	155	6.10	225	8.86	22	0.87	M25
75	C	155	6.10	255	10.04	23.5	0.93	M32
80	C	180	7.09	280	11.02	26	1.02	M32
85	C	200	7.87	320	12.60	28	1.10	M32
90	D	125	4.92	380	14.96	38	1.50	M32

CHICAGO VIBRATOR PRODUCTS 1-800-842-7284 USA & CANADA  
1-630-920-9411 INTERNATIONAL

The range of MVE-type motovibrators is the result of some forty years of experience in vibrating technology for the building industry as well as for other industrial applications worldwide. Our rotary vibrators afford a guarantee of long-term durability, reflecting the care taken over selection of components and the high level of precision adopted in manufacture, whilst maintenance is minimal and simple in the extreme.



### 2 poles - 3600 rpm

Type	Size	ELECTRICAL DATA				MECHANICAL DATA																	weight	weight		
		Max Power kw	Max Power Hp	Max current		Working Moment in* lbs	Centrifugal Force lbs	F <sub>fig</sub>	Overall dimensions																	
				A					c		d		e		f		h		i		m				n	
<b>230/460 V - 60 Hz 3PH</b>				230V ( Δ )	460V ( Y )				mm	inch	mm	inch	mm	inch	mm	inch	mm	inch	mm	inch	mm	inch	mm	inch	kg	lbs
MVE 160/2	10	0.08	0.11	0.36	0.18	0.71	130	A	211	8.31	130	5.12	136	5.35	12	0.47	1.89	3.70	4.76	1.77	3.39	4.2	9.26			
MVE 220/2	10	0.10	0.13	0.36	0.18	1.31	243	A	211	8.31	130	5.12	136	5.35	12	0.47	1.89	3.70	4.76	1.77	3.39	4.6	10.14			
MVE 440/2	20	0.18	0.24	0.70	0.35	2.26	417	B	217	8.54	130	5.12	158	6.22	14	0.55	2.52	4.72	4.84	1.57	4.41	7.0	15.43			
MVE 690/2	30	0.27	0.36	0.90	0.45	3.86	712	C	259	10.20	155	6.10	177	6.97	14	0.55	3.15	5.67	6.50	1.69	5.20	9.8	21.61			
MVE 890/2	30	0.30	0.40	1.20	0.60	4.91	906	C	259	10.20	155	6.10	177	6.97	14	0.55	3.15	5.67	6.50	1.69	5.20	10.3	22.71			
MVE 1200/2	40	0.50	0.67	1.94	0.97	6.38	1177	C	338	13.31	168	6.61	202	7.95	22	0.87	3.62	6.61	7.01	2.95	6.22	15.8	34.83			
MVE 1700/2	40	0.66	0.89	2.48	1.24	9.14	1687	C	338	13.31	168	6.61	202	7.95	22	0.87	3.62	6.61	7.01	2.95	6.22	16.5	36.38			
MVE 1800/2	50	0.75	1.01	3.00	1.50	9.57	1764	C	311	12.24	209	8.23	211	8.31	22	0.87	3.70	7.09	8.07	1.85	6.69	20.6	45.42			
MVE 2300/2	50	0.95	1.27	3.90	1.95	12.11	2233	C	397	15.63	209	8.23	211	8.31	22	0.87	3.70	7.09	8.07	3.54	6.69	21.6	47.62			
MVE 3100/2	50	1.30	1.74	4.50	2.25	16.31	3009	C	397	15.63	209	8.23	211	8.31	22	0.87	3.70	7.09	8.07	3.54	6.69	22.0	48.50			
MVE 3500/2	60	1.57	2.11	5.22	2.61	19.22	3545	C	448	17.64	228	8.98	243	9.57	30	1.18	4.72	9.68	8.66	3.86	8.70	51.2	112.88			
MVE 4100/2	60	2.00	2.68	6.84	3.42	23.88	4403	C	448	17.64	228	8.98	243	9.57	30	1.18	4.72	9.68	8.66	3.86	8.70	52.0	114.64			
MVE 5100/2	60	2.40	3.22	7.88	3.94	27.57	5084	C	448	17.64	228	8.98	243	9.57	30	1.18	4.72	9.68	8.66	3.86	8.70	51.6	113.76			
MVE 7600/2	75	2.90	3.89	9.22	4.61	37.97	7002	C	538	21.18	299	11.77	311	12.24	35	1.38	5.51	11.61	10.75	4.53	10.43	101.4	223.55			
MVE 8800/2	75	2.90	3.89	9.22	4.61	48.43	8933	C	538	21.18	299	11.77	311	12.24	35	1.38	5.51	11.61	10.75	4.53	10.43	103.8	228.84			
MVE 11500/2	75	4.00	5.36	12.56	6.28	60.35	11129	C	588	23.15	299	11.77	311	12.24	35	1.38	5.51	11.61	10.75	5.51	10.43	105.8	233.25			
<b>460/796 V - 60 Hz 3PH</b>		kw	Hp	460V ( Δ )	796V ( Y )				c	d	e	f	h	i	l	m	n	kg	lbs							
MVE 14400/2	85	5.50	7.38	8.00	4.62	78.32	14445	C	605	23.82	378	14.88	383	15.08	50	1.97	7.87	16.69	12.79	4.72	14.88	229.6	506.19			
MVE 20100/2	85	10.00	13.41	18.00	10.40	112.07	20668	C	605	23.82	378	14.88	383	15.08	50	1.97	7.87	16.69	12.79	4.72	14.88	234.7	517.43			

### 2 poles - 3600 rpm singlephase

Type	Size	ELECTRICAL DATA				MECHANICAL DATA																	weight	weight		
		Max Power kw	Max Power Hp	Max current		Working Moment in* lbs	Centrifugal Force lbs	F <sub>fig</sub>	Overall dimensions																	
				A					c		d		e		f		h		i		m				n	
<b>115 V - 60 Hz 1PH</b>				115V 60Hz					mm	inch	mm	inch	mm	inch	mm	inch	mm	inch	mm	inch	mm	inch	mm	inch	kg	lbs
MVE 160/2M	10	0.08	0.11	1.03		0.71	130	A	211	8.31	130	5.12	136	5.35	12	0.47	1.89	3.70	4.76	1.77	3.39	4.2	9.26			
MVE 220/2M	10	0.10	0.13	1.3		1.31	243	A	211	8.31	130	5.12	136	5.35	12	0.47	1.89	3.70	4.76	1.77	3.39	4.6	10.14			
MVE 440/2M	20	0.18	0.24	1.63		2.26	417	B	217	8.54	130	5.12	158	6.22	14	0.55	2.52	4.72	4.84	1.57	4.41	7.0	15.43			
MVE 690/2M	30	0.27	0.36	3.48		3.86	712	C	259	10.20	155	6.10	177	6.97	14	0.55	3.15	5.67	6.50	1.69	5.20	9.8	21.61			

### 4 poles - 1800 rpm

Type	Size	ELECTRICAL DATA				MECHANICAL DATA																	weight	weight		
		Max Power kw	Max Power Hp	Max current		Working Moment in* lbs	Centrifugal Force lbs	F <sub>fig</sub>	Overall dimensions																	
				A					c		d		e		f		h		i		m				n	
<b>230/460 V - 60 Hz 3PH</b>				230V ( Δ )	460V ( Y )				mm	inch	mm	inch	mm	inch	mm	inch	mm	inch	mm	inch	mm	inch	mm	inch	kg	lbs
MVE 70/4	10	0.04	0.05	0.62	0.31	1.72	79	A	211	8.31	130	5.12	136	5.35	12	0.47	1.89	3.70	4.76	1.77	3.39	4.6	10.14			
MVE 200/4	20	0.09	0.12	0.50	0.25	3.63	168	B	217	8.54	130	5.12	158	6.22	14	0.55	2.52	4.72	4.84	1.57	4.41	7.4	16.31			
MVE 400/4	30	0.16	0.21	1.00	0.50	9.37	432	C	259	10.20	155	6.10	177	6.97	14	0.55	3.15	5.67	6.50	1.69	5.20	11.8	26.01			
MVE 860/4	40	0.30	0.40	1.72	0.86	20.22	933	C	338	13.31	168	6.61	202	7.95	22	0.87	3.62	6.61	7.01	2.95	6.22	19.5	42.99			
MVE 1150/4	40	0.35	0.47	2.18	1.09	24.29	1120	C	338	13.31	168	6.61	202	7.95	22	0.87	3.62	6.61	7.01	2.95	6.22	21.0	46.30			
MVE 1530/4	50	0.62	0.83	2.82	1.41	34.05	1570	C	397	15.63	209	8.23	211	8.31	22	0.87	3.70	7.09	8.07	3.54	6.69	27.4	60.41			
MVE 2300/4	50	0.65	0.87	3.40	1.70	53.65	2474	C	451	17.75	209	8.23	211	8.31	22	0.87	3.70	7.09	8.07	4.41	6.69	35.8	78.93			
MVE 3100/4	60	0.90	1.21	3.56	1.78	66.37	3060	C	448	17.64	228	8.98	243	9.57	30	1.18	4.72	9.68	8.66	3.86	8.70	58.2	128.31			
MVE 3880/4	60	1.15	1.54	4.18	2.09	79.57	3668	C	448	17.64	228	8.98	243	9.57	30	1.18	4.72	9.68	8.66	3.86	8.70	59.4	130.96			
MVE 5340/4	60	1.60	2.15	6.40	3.20	118.82	5478	C	510	20.08	228	8.98	243	9.57	30	1.18	4.72	9.68	8.66	5.08	8.70	62.0	136.69			
MVE 5700/4	70	1.80	2.41	6.80	3.40	117.34	5410	C	522	20.55	274	10.79	272	10.71	38	1.50	5.43	10.51	9.84	4.84	9.25	84.0	185.19			
MVE 6840/4	70	1.90	2.55	7.60	3.80	146.84	6770	C	522	20.55	274	10.79	272	10.71	38	1.50	5.43	10.51	9.84	4.84	9.25	87.0	191.80			
MVE 8400/4	75	2.20	2.95	8.30	4.15	177.11	8166	C	588	23.15	299	11.77	311	12.24	35	1.38	5.51	11.61	10.75	5.51	10.43	118.4	261.03			
MVE 9480/4	75	2.50	3.35	11.60	5.80	208.43	9610	C	588	23.15	299	11.77	311	12.24	35	1.38	5.51	11.61	10.75	5.51	10.43	123.6	272.49			
MVE 12260/4	80	3.60	4.83	13.20	6.60	262.75	12114	C	603	23.74	330	12.99	346	13.62	35	1.38	6.30	13.58	11.97	5.12	12.24	190.0	418.88			
<b>460/796 V - 60 Hz 3PH</b>		kw	Hp	460V ( Δ )	796V ( Y )				c	d	e	f	h	i	l	m	n	kg	lbs							
MVE 15850/4	85	5.00	6.71	9.41	5.44	343.70	15847	C	605	23.82	378	14.88	383	15.08	50	1.97	7.87	13.78	12.79	4.72	14.88	246.6	543.66			
MVE 19800/4	85	7.50	10.06	12.00	6.94	431.45	19892	C	605	23.82	378	14.88	383	15.08	50	1.97	7.87	13.78	12.79	4.72	14.88	257.8	568.36			
MVE 21000/4	90	7.80	10.46	13.00	7.51	508.91	23464	D	686																	

These are some of the features of our electric vibrators:

- Continuous operation at 100 % force output
- Winding insulation class H, also to include lead wires
- Tropicalized windings
- IP65-water tight, dust tight
- Ambient temperature: -4° F to 104° F,

- paint: powder painting RAL 2004 (orange)

- Frames 10 to 50; casing: pressurized aluminum; flanges: cast iron; caps: pressurized aluminum.

- Frames 60 to 90; casing: cast iron; flanges: cast iron; caps: steel.

Comply with ATEX EN 50281 and EN 50014,  II 3 D (surface industry, category 3, atmosphere D, zone 22)

**6 poles - 1200 rpm**

		ELECTRICAL DATA						MECHANICAL DATA																
Type	Size	Max Power	Max Power	Max current		Working Moment	Centrifugal Force	F <sub>10</sub>	Overall dimensions												weight	weight		
230/460 V - 60 Hz 3PH		kw	Hp	A		in* lbs	lbs		c		d		e		f		h		i		l		kg	lbs
				230V ( Δ )	460V ( Y )				mm	inch	mm	inch	mm	inch	mm	inch	mm	inch	mm	inch	mm	inch		
MVE 90/6	30	0.12	0.16	0.80	0.40	5.70	117	C	259	10.20	155	6.10	177	6.97	14	0.55	3.15	5.67	6.50	1.69	5.20	10.4	22.93	
MVE 220/6	30	0.12	0.16	0.80	0.40	11.40	234	C	299	11.77	155	6.10	177	6.97	14	0.55	3.15	5.67	6.50	2.48	5.20	12.2	26.90	
MVE 410/6	40	0.18	0.24	1.02	0.51	20.22	414	C	338	13.31	168	6.61	202	7.95	22	0.87	3.62	6.61	7.01	2.95	2.28	19.6	43.21	
MVE 680/6	50	0.35	0.47	1.28	0.64	28.94	593	C	397	15.63	209	8.23	211	8.31	22	0.87	3.70	7.09	8.07	3.54	6.69	26.6	58.64	
MVE 1100/6	50	0.35	0.47	2.30	1.15	51.53	1056	C	451	17.75	209	8.23	211	8.31	22	0.87	3.70	7.09	8.07	4.41	6.69	34.0	74.96	
MVE 1730/6	60	0.68	0.91	2.52	1.26	93.93	1925	C	448	17.64	228	8.98	243	9.57	30	1.18	4.72	9.68	8.66	3.86	8.70	59.4	130.96	
MVE 2350/6	60	0.75	1.01	2.64	1.32	118.78	2434	C	510	20.08	228	8.98	243	9.57	30	1.18	4.72	9.68	8.66	5.08	8.70	73.0	160.94	
MVE 3090/6	60	1.10	1.48	4.00	2.00	169.99	3483	C	562	22.12	228	8.98	243	9.57	30	1.18	4.72	9.68	8.66	6.06	8.70	76.5	168.65	
MVE 3580/6	70	1.10	1.48	6.44	3.22	176.01	3607	C	556	21.89	274	10.79	272	10.71	38	1.50	5.43	10.51	9.84	5.51	9.25	89.0	196.21	
MVE 4740/6	70	1.50	2.01	6.00	3.00	215.17	4409	C	616	24.25	274	10.79	272	10.71	38	1.50	5.43	10.51	9.84	6.69	9.25	100.5	221.57	
MVE 5690/6	75	1.96	2.63	6.76	3.38	265.31	5437	C	708	27.87	299	11.77	311	12.24	35	1.38	5.51	11.61	10.75	7.87	10.43	131.5	289.91	
MVE 6620/6	75	2.20	2.95	8.60	4.30	328.47	6731	C	708	27.87	299	11.77	311	12.24	35	1.38	5.51	11.61	10.75	7.87	10.43	137.8	303.80	
MVE 8450/6	80	2.50	3.35	9.76	4.88	378.38	7754	C	683	26.89	330	12.99	346	13.62	35	1.38	6.30	13.58	11.97	6.69	12.24	194.8	429.46	
MVE 10370/6	80	3.20	4.29	12.00	6.00	505.34	10355	C	733	28.86	330	12.99	346	13.62	35	1.38	6.30	13.58	11.97	7.68	12.24	212.4	468.27	
MVE 11500/6	85	3.80	5.10	12.72	6.36	566.24	11603	C	645	25.39	378	14.88	383	15.08	50	1.97	7.87	16.69	12.79	5.51	14.88	264.2	582.47	
MVE 14360/6	85	4.30	5.77	15.62	7.81	712.77	14606	C	685	26.97	378	14.88	383	15.08	50	1.97	7.87	16.69	12.79	6.30	14.88	280.7	618.84	
460/796 V - 60 Hz 3PH		kw	Hp	460V ( Δ )	796V ( Y )	in* lbs	lbs		c		d		e		f		h		i		l		kg	lbs
MVE 17750/6	85	7.10	9.52	11.60	6.71	804.33	16482	C	785	30.90	378	14.88	383	15.08	50	1.97	7.87	16.69	12.79	8.27	14.88	290.0	639.35	
MVE 19120/6	85	7.50	10.06	12.60	7.28	1007.98	20655	C	785	30.90	378	14.88	383	15.08	50	1.97	7.87	16.69	12.79	8.27	14.88	307.6	678.15	
MVE 21400/6	90	7.60	10.19	12.70	7.34	1072.65	21980	D	826	32.52	448	17.64	420	16.53	45	1.77	7.95	16.69	14.45	8.27	14.92	359.3	792.13	
MVE 28660/6	90	10.00	13.41	16.00	9.25	1425.10	29202	D	926	36.45	448	17.64	420	16.53	45	1.77	7.95	16.69	14.45	10.24	14.92	375.6	828.06	

**8 poles - 900 rpm**

		ELECTRICAL DATA						MECHANICAL DATA																
Type	Size	Max Power	Max Power	Max current		Working Moment	Centrifugal Force	F <sub>10</sub>	Overall dimensions												weight	weight		
230/460 V - 60 Hz 3PH		kw	Hp	A		in* lbs	lbs		c		d		e		f		h		i		l		kg	lbs
				230V ( Δ )	460V ( Y )				mm	inch	mm	inch	mm	inch	mm	inch	mm	inch	mm	inch	mm	inch		
MVE 330/8	40	0.23	0.31	2.28	1.14	28.88	333	C	338	13.31	168	6.61	202	7.95	22	0.87	3.62	6.61	7.01	2.95	6.22	21.4	47.18	
MVE 550/8	50	0.35	0.47	2.30	1.15	49.54	571	C	451	17.75	209	8.23	211	8.31	22	0.87	3.70	7.09	8.07	4.41	6.69	29.5	65.04	
MVE 880/8	50	0.35	0.47	2.30	1.15	72.68	838	C	451	17.75	209	8.23	211	8.31	22	0.87	3.70	7.09	8.07	4.41	6.69	35.0	77.16	
MVE 1430/8	60	0.50	0.67	2.40	1.20	118.78	1369	C	510	20.08	228	8.98	243	9.57	30	1.18	4.53	9.68	8.66	5.08	8.70	64.7	142.64	
MVE 2000/8	60	0.65	0.87	2.58	1.29	162.39	1872	C	510	20.08	228	8.98	243	9.57	30	1.18	4.53	9.68	8.66	5.08	8.70	71.0	156.53	
MVE 2900/8	70	1.00	1.34	3.66	1.83	259.17	2987	C	556	21.89	274	10.79	272	10.71	38	1.50	5.43	10.51	9.84	5.51	9.25	99.8	220.02	
MVE 4620/8	75	1.50	2.01	5.78	2.89	404.33	4661	C	708	27.87	299	11.77	311	12.24	35	1.38	5.51	11.61	10.75	7.87	10.43	150.4	331.58	
MVE 6820/8	80	2.00	2.68	7.54	3.77	588.53	6784	C	683	26.89	330	12.99	346	13.62	35	1.38	6.30	13.58	11.97	6.69	12.24	212.2	467.82	
MVE 8360/8	80	2.50	3.35	12.00	6.00	725.29	8360	C	733	28.86	330	12.99	346	13.62	35	1.38	6.30	13.58	11.97	7.68	12.24	230.2	507.51	
MVE 9240/8	85	2.90	3.89	13.00	6.50	804.27	9270	C	645	25.39	378	14.88	388	15.27	50	1.97	7.87	16.69	12.79	5.51	14.88	284.5	627.22	
MVE 11660/8	85	4.00	5.36	16.00	8.00	1007.98	11618	C	685	26.97	378	14.88	388	15.27	50	1.97	7.87	16.69	12.79	6.30	14.88	305.0	672.42	
MVE 14300/8	85	5.00	6.71	20.00	10.00	1242.08	14317	C	785	30.90	378	14.88	388	15.27	50	1.97	7.87	16.69	12.79	8.27	14.88	324.4	715.19	
460/796 V - 60 Hz 3PH		kw	Hp	460V ( Δ )	796V ( Y )	in* lbs	lbs		c		d		e		f		h		i		l		kg	lbs
MVE 22000/8	90	6.80	9.12	12.50	7.23	1903.49	21940	D	926	36.45	448	17.64	420	16.53	45	1.77	7.95	16.69	14.45	10.24	14.92	422.2	930.80	

\* = Working moment = 2 x static moment

CHICAGO VIBRATOR PRODUCTS 1-800-842-7284 USA & CANADA  
1-630-920-9411 INTERNATIONAL