



D Series Bolt-on Style



C3 Series



CC Series – Clamp-on Style

Hydraulic Design Series Vibrators – Performance Data

| VIBRATOR MODEL | UNBALANCE | START-UP | SPEED | FLOW | FORCE | SPEED | FLOW | FORCE | SPEED | FLOW | FORCE |
|-------------------|-----------|----------|-------|------|-------|-------|------|-------|-------|------|-------|
| | LB-IN | PSI | RPM | GPM | LBS | RPM | GPM | LBS | RPM | GPM | LBS |
| | N-M | BAR | --- | LPM | KN | --- | LPM | KN | --- | LPM | KN |
| C3-1.5-2HC | 1.5 | 80 | 3,000 | 1.7 | 380 | 4,000 | 2.2 | 680 | 5,000 | 2.8 | 1,070 |
| | 0.2 | 5.5 | --- | 6.4 | 2 | --- | 8.3 | 3 | --- | 10.6 | 5 |
| C3-2.0-2HC | 2 | 105 | 3,000 | 1.7 | 510 | 4,000 | 2.2 | 910 | 5,000 | 2.8 | 1,420 |
| | 0.2 | 7.2 | --- | 6.4 | 2 | --- | 8.3 | 4 | --- | 10.6 | 6 |
| C3-2.5-2HC | 2.5 | 130 | 3,000 | 1.7 | 640 | 4,000 | 2.2 | 1,140 | 5,000 | 2.8 | 1,780 |
| | 0.3 | 9 | --- | 6.4 | 3 | --- | 8.3 | 5 | --- | 10.6 | 8 |
| C3-3.0-2HC | 3 | 155 | 3,000 | 1.7 | 770 | 4,000 | 2.2 | 1,360 | 5,000 | 2.8 | 2,130 |
| | 0.3 | 10.7 | --- | 6.4 | 3 | --- | 8.3 | 6 | --- | 10.6 | 9 |
| C3-4.0-2HC | 4 | 200 | 3,000 | 1.7 | 1,020 | 4,000 | 2.2 | 1,820 | 5,000 | 2.8 | 2,840 |
| | 0.5 | 13.8 | --- | 6.4 | 5 | --- | 8.3 | 8 | --- | 10.6 | 13 |
| C3-5.0-2HC | 5 | 250 | 3,000 | 1.7 | 1,280 | 4,000 | 2.2 | 2,270 | 5,000 | 2.8 | 3,550 |
| | 0.6 | 17.2 | --- | 6.4 | 6 | --- | 8.3 | 10 | --- | 10.6 | 16 |
| C3-6.0-2HC | 6 | 300 | 3,000 | 1.7 | 1,530 | 4,000 | 2.2 | 2,730 | 5,000 | 2.8 | 4,260 |
| | 0.7 | 20.7 | --- | 6.4 | 7 | --- | 8.3 | 12 | --- | 10.6 | 19 |
| C3-1.5-5HC | 1.5 | 0 | 3,000 | 5 | 380 | 4,000 | 6.7 | 680 | 5,000 | 8.4 | 1,070 |
| | 0.2 | 0 | --- | 18.9 | 2 | --- | 25.4 | 3 | --- | 31.8 | 5 |
| C3-2.0-5HC | 2 | 0 | 3,000 | 5 | 510 | 4,000 | 6.8 | 910 | 5,000 | 8.4 | 1,420 |
| | 0.2 | 0 | --- | 18.9 | 2 | --- | 25.6 | 4 | --- | 31.8 | 6 |
| C3-2.5-5HC | 2.5 | 0 | 3,000 | 5 | 640 | 4,000 | 6.7 | 1,140 | 5,000 | 8.4 | 1,780 |
| | 0.3 | 0 | --- | 18.9 | 3 | --- | 25.4 | 5 | --- | 31.8 | 8 |
| C3-3.0-5HC | 3 | 0 | 3,000 | 5 | 770 | 4,000 | 6.7 | 1,360 | 5,000 | 8.4 | 2,130 |
| | 0.3 | 0 | --- | 18.9 | 3 | --- | 25.4 | 6 | --- | 31.8 | 9 |
| C3-4.0-5HC | 4 | 0 | 3,000 | 5 | 1,020 | 4,000 | 6.7 | 1,820 | 5,000 | 8.4 | 2,840 |
| | 0.5 | 0 | --- | 18.9 | 5 | --- | 25.4 | 8 | --- | 31.8 | 13 |
| C3-5.0-5HC | 5 | 0 | 3,000 | 5 | 1,280 | 4,000 | 6.7 | 2,270 | 5,000 | 8.4 | 3,550 |
| | 0.6 | 0 | --- | 18.9 | 6 | --- | 25.4 | 10 | --- | 31.8 | 16 |
| C3-6.0-5HC | 6 | 0 | 3,000 | 5 | 1,530 | 4,000 | 6.7 | 2,730 | 5,000 | 8.4 | 4,260 |
| | 0.7 | 0 | --- | 18.9 | 7 | --- | 25.4 | 12 | --- | 31.8 | 19 |
| D4.5-6-5HC | 6 | 110 | 3,000 | 5 | 1,530 | 4,000 | 6.7 | 2,730 | 5,000 | 8.4 | 4,260 |

| | | | | | | | | | | | |
|-----------------------------|-----------|-------------|--------------|-------------|--------------|--------------|--------------|---------------|--------------|--------------|---------------|
| CC4.5-6-5HC | 0.7 | 7.6 | --- | 18.9 | 7 | --- | 25.4 | 12 | --- | 31.8 | 19 |
| D4.5-8-5HC CC4.5-8-5HC | 8 0.9 | 140 9.7 | 3,000 --- | 5 18.9 | 2,040 9 | 4,000 --- | 6.7 25.4 | 3,640 16 | 5,000 --- | 8.4 31.8 | 5,680 25 |
| D4.5-10-5HC CC4.5-10-5HC | 10 1.1 | 180 12.4 | 3,000 --- | 5 18.9 | 2,560 11 | 4,000 --- | 6.7 25.4 | 4,540 20 | 5,000 --- | 8.4 31.8 | 7,100 32 |
| D7-12-8HC CC7-12-5HC | 12 1.4 | 120 8.3 | 3,000 --- | 9.1 34.4 | 3,070 14 | 4,000 --- | 12.1 45.8 | 5,450 24 | 5,000 --- | 15.1 57.2 | 8,520 38 |
| D7-18-8HC CC7-18-8HC | 18 2 | 180 12.4 | 3,000 --- | 9.1 34.4 | 4,600 20 | 4,000 --- | 12.1 45.8 | 8,180 36 | 5,000 --- | 15.1 57.2 | 12,780 57 |
| D7-25-8HC CC7-25-8HC | 25 2.8 | 250 17.2 | 3,000 --- | 9.1 34.4 | 6,390 28 | 4,000 --- | 12.1 45.8 | 11,360 51 | 5,000 --- | 15.1 57.2 | 17,750 79 |
| D7-50-8HC CC7-50-8HC | 50 5.7 | 490 33.8 | 3,000 --- | 9.1 34.4 | 12,780 57 | 4,000 --- | 12.1 45.8 | 22,720 101 | 5,000 --- | 15.1 57.2 | 35,500 158 |

Hydraulic Design Series Vibrators - Dimensional Data

| VIBRATOR MODEL | WEIGHT | A | B | C | D | E | F | G | HYDRAULIC MOTOR PORT SIZE | |
|----------------|--------|--------|-------|-------|--------|-----------|--------------|--------|---------------------------|----|
| | HEIGHT | LENGTH | WIDTH | | | BOLT HOLE | BOLT CENTERS | | | |
| | LBS | IN | IN | IN | IN | IN | IN | IN | | IN |
| | KG | MM | MM | MM | MM | MM | MM | MM | | |
| C3 | 40.00 | 8.2 | 9.25 | 11.00 | 3.00 | 0.9 | 0.78 | 8 | 3/4 - 16 SAE | |
| | 18.14 | 208.28 | 235 | 279 | 76.20 | 22.86 | 19.812 | 203.2 | --- | |
| D4.5 | 49.00 | 8.4 | 12.10 | 10.80 | 4.10 | 1 | 0.66 | --- | 3/4 - 16 SAE | |
| | 22.23 | 213.36 | 307 | 274 | 104.14 | 25.4 | 16.764 | --- | --- | |
| D7 | 98.00 | 11.5 | 18.00 | 13.00 | 6.00 | 1.4 | 0.78 | --- | 3/4 - 14 NPT | |
| | 44.45 | 292.1 | 457 | 330 | 152.40 | 35.56 | 19.812 | --- | --- | |
| CC4.5 | 56.00 | 8.6 | 12.60 | 10.80 | 1.10 | --- | --- | 9.2 | 3/4 - 16 SAE | |
| | 25.40 | 218.44 | 320 | 274 | 27.94 | --- | --- | 233.68 | --- | |
| CC7 | 90.00 | 11.5 | 14.80 | 13.50 | 1.10 | --- | --- | 11.5 | 3/4 - 14 NPT | |
| | 40.82 | 292.1 | 376 | 343 | 27.94 | --- | --- | 292.1 | --- | |

| Hydraulic Design Series Vibrators | | | |
|-----------------------------------|----------------------|----------------------|---------------|
| Hydraulic Motor | 2HC | 5HC | 8HC |
| Port Size | 3/4" - 16 SAE O-RING | 3/4" - 16 SAE O-RING | 3/4" - 14 NPT |
| Minimum Hose Size | 1/2" ID | 5/8" ID | 3/4" ID |
| Displacement | 0.129 CU IN | 0.388 CU IN | 0.698 CU IN |
| --- | 2.11 CC | 6.36 CC | 11.43 CC |
| Maximum Speed | 5,000 RPM | 5,000 RPM | 5,000 RPM |
| Flow at | 2.8 GPM | 8.4 GPM | 15.1 GPM |
| Maximum Speed | 17.7 LPM | 38 LPM | 69 LPM |
| Maximum Continuous Pressure | 3,000 PSI | 1,600 PSI | 2,000 PSI |
| --- | 207 BAR | 110 BAR | 138 BAR |
| Maximum Intermittent Pressure | 4,000 PSI | 2,500 PSI | 3,000 PSI |
| --- | 276 BAR | 172 BAR | 207 BAR |
| Maximum Back Pressure | 350 PSI | 350 PSI | 350 PSI |

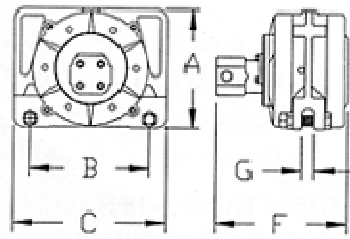

CC7 — HYDRAULIC

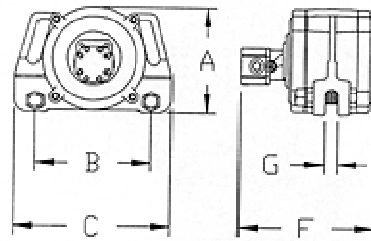

CC4.5 — HYDRAULIC

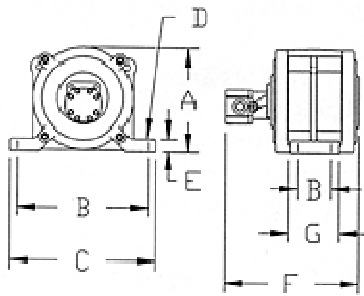

D4.5 — HYDRAULIC

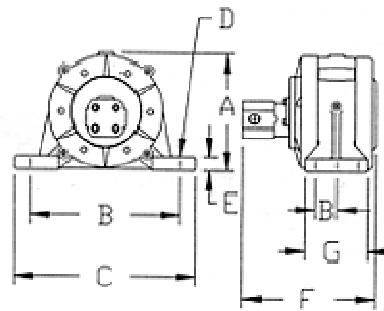

D7 — HYDRAULIC

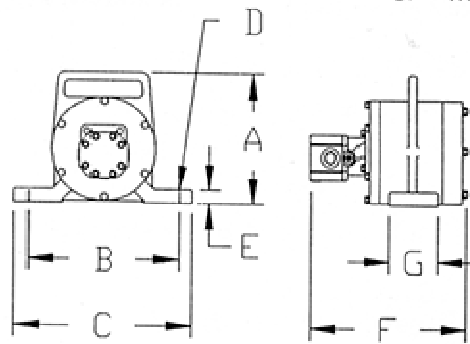

C3 — HYDRAULIC

CHICAGO VIBRATOR PRODUCTS

Division of CVP Group, Inc.

Westmont, IL 60559

www.chicagovibrator.com

800-842-7284

866-247-7538 (F)

solutions@chivib.com