

PD-200

Pneumatic Post Driver

Part No. 070756 - 7" chuck

Part No. 070745 - 5" chuck



Pneumatic • Hydraulic • Gasoline
Professional Grade Tools

The PD-200 Heavy Duty Post Pounder is the perfect choice for driving Beams, Round, Square or Rectangular Tubing, Wood Posts, and Stakes of any shape. Capable of outperforming a 90 lb. Jack Hammer, the PD-200 features an Alloy Steel piston and 5-1/2" or 7" Master Chuck.

- At 170 pounds, the PD-200 drives large, heavy post quickly and securely.
- Delivering up to 930 blows per minute, and capable of driving guardrail and other heavy-duty posts.

Specifications	PD-200	PD-200
Duty	Heavy Duty	Heavy Duty
Air Consumption (CFM@100 psi)	72	72
Wt. lb (kg)	170 (77.11)	177 (80.28)
Ship Wt. lb (kg)	175 (79.37)	182 (82.55)
Master Chuck	5-1/2" (139.7mm) ID	7" (177.8mm) I.D.
Applications		
2" Pipe	X [•]	X [•]
2-1/2" Pipe	X [•]	X [•]
3" Pipe	X ^{•◆}	X ^{•◆}
3-1/2" Pipe	X ^{•◆}	X ^{•◆}
4" Pipe	X ^{•◆}	X ^{•◆}
5" to 6" Pipe		X ^{•◆}
Telespar Post	X [•]	X [•]
Telespar Post Breakaway Anchor 2-1/2"	X ^{•◆}	X ^{•◆}
Telespar Post Breakaway Anchor 3"	X ^{•◆}	X ^{•◆}
C Post	X [•]	X [•]
Super C Post	X [•]	X [•]
Well Points (Sand Points)	X [•]	X [•]
4" x 4" Wood Post	X	X [•]
4" x 6" H Column Guardrail Post	X ^{■◆}	X ^{■◆}
6" x 6" Wood Posts	X [■]	X [■]
12" Sheet Piling	X [■]	X [■]



- Low air consumption and high-quality components, mean low-cost, low-maintenance post driving
- Additional driving options possible with easy bolt-on adapters. Bolt on adapters sold separately.

■An optional master chuck is required ●An adapter is required
◆A driving cap is required ◆Indicates a combination of accessories is required

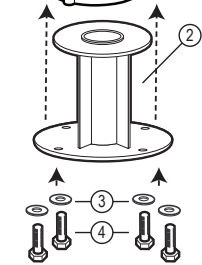
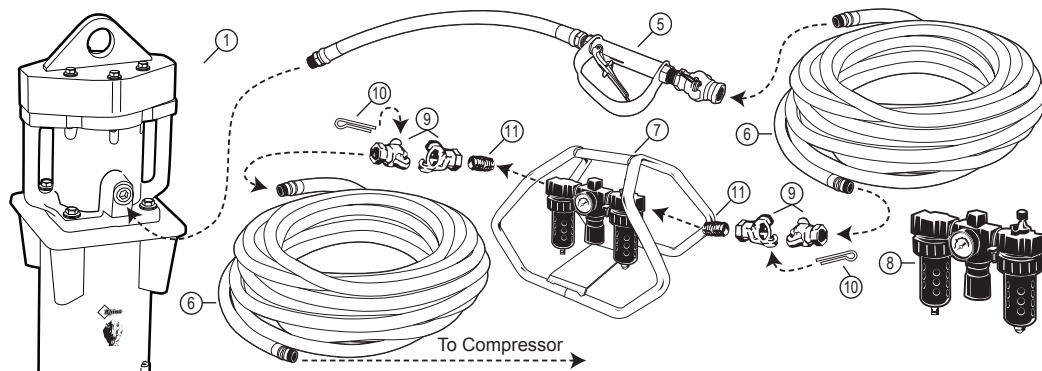

Items illustrated
above sold
separately

No.	Part No.	Description
1	070756	PD-200 Post Driver w/7" Chuck
	070745	PD-200 Post Driver w/5 1/2" Chuck
2	070839	2-1/2" Chuck Adapter (See Chart 1 for more options)
3	517702	Compression Washers (Qty. 4)
4	500007	Cap Screws (Qty. 4)
5	600000	Throttle Valve Kit
6	607000	Hose Assembly*
7	225001	Carrier for FRL
8	601128	Filter-Regulator-Lubricator
9	606600	Air Line Coupler
10	606601	Coupler Safety Clip (limit 4 per order)
11	230401	3/4" Close Nipple

*Made to order at desired length - additional charge per foot of hose

Chuck adapters and part numbers. 3" and 3.5" Drive Cap Required for driving 3" and 3.5" Schedule 40 Pipe. See Chart 1 for size information.



Chart 1 - Master chuck and chuck adapter sizes and part numbers.

Chuck/Adapter/Drive Cap	PD-200 (5-1/2")	PD-200 (7")
Description/Actual ID-in (mm)	Part No.	Part No.
7" (177.8) Master Chuck		070758
5-1/2" (139.7) Master Chuck		070746
5-3/4" (146)		070791
5-1/4" (133.4)		070790
5" (133.4)		070837
4-3/4" (120.6)	070785	070789
4-1/4" (107.9)	070784	070788
3-3/4" (95.3)	070783	070787
3-1/8" (79.4)	070782	070786
2-1/2" (63.5)	070842	070839
4"x4" Square for Wood/Metal	Master Chuck	070837
Slotted Sheet Pile Chuck	070597	070597
4-3/4" Master Chuck	070644	070644
4"x6" Master Chuck H Column Guardrail (070062 also required)	070061	070061
Drive Cap	070062	070062
6"x6" Square Master Chuck	070761	070761

All adapters come with required hardware
Special Order adaptors available - call for quote



A Tradition of Quality and Service Since 1975