

# PD-110

**Pneumatic Post Driver**  
**Part No. 070014**



**Pneumatic • Hydraulic • Gasoline**  
**Professional Grade Tools**

The Rhino PD-110 Pneumatic Post Driver combines easier handling than an equipment supported driver but has a slight advantage over the PD-55 in driving speed and heavy soil tolerance. Plus, the PD-110 provides better soil stabilization when driving the post at a deeper soil level is required. The PD-110 takes post driving capabilities to the next level. It is suited for driving 2" to 4" pipe and tube, structural forms, pin piles, dock piles, and 4x4 wood.

- At 109 pounds, with a 4" Alloy Steel piston, the PD-110 provides better handling in tough sites.
- Delivers up to 1700 blows per minute, and capable of driving a 2" O.D. post, ten to fifteen feet deep.
- No additional equipment required. Can be lifted by two people.
- Additional driving options possible with easy bolt-on adapters

Specifications	PD-110
Duty	Heavy
Air Consumption (CFM@100 psi)	64
Wt. lb (kg)	109.16 (49.5)
Ship Wt. lb (kg)	117 (53)
Master Chuck	4 1/4" (107.9) ID
Applications	
1-1/4" to 1-1/2" Pipe	X•
1-5/8" Round Post	X•
2" Pipe	X•
2-1/2" Pipe	X•
3" Pipe	X•◆
3-1/2" Pipe	X◆
4" Pipe	X■◆
T-Posts	X•
Telespar Post	X•
Telespar Post Breakaway Anchor 2-1/2"	X•◆
1.2 to 1.5 lbs/ft Channel Post	X•
2 to 2.75 lbs/ft Channel Post	X•
3 to 4 lbs/ft Channel Post	X•
Channel Post Breakaway Anchor	X•◆
C Post	X
4" x 4" Wood Post	X■
4" x 6" H Column Guardrail Post	X■◆

■An optional master chuck is required    ●An adapter is required  
◆A driving cap is required    ◆Indicates a combination of accessories is required



Bolt-on adapters sold separately.

**A Tradition of Quality and Service Since 1975**

Distributed By Chicago Vibrator Products | 800-842-7284 | Solutions@ChiVib.com | [www.ChicagoVibrator.com](http://www.ChicagoVibrator.com)

© Copyright 2017 Rhino Tool Company, Inc.

# PD-110

**Pneumatic Post Driver**  
Part No. 070014



**Pneumatic • Hydraulic • Gasoline**  
**Professional Grade Tools**

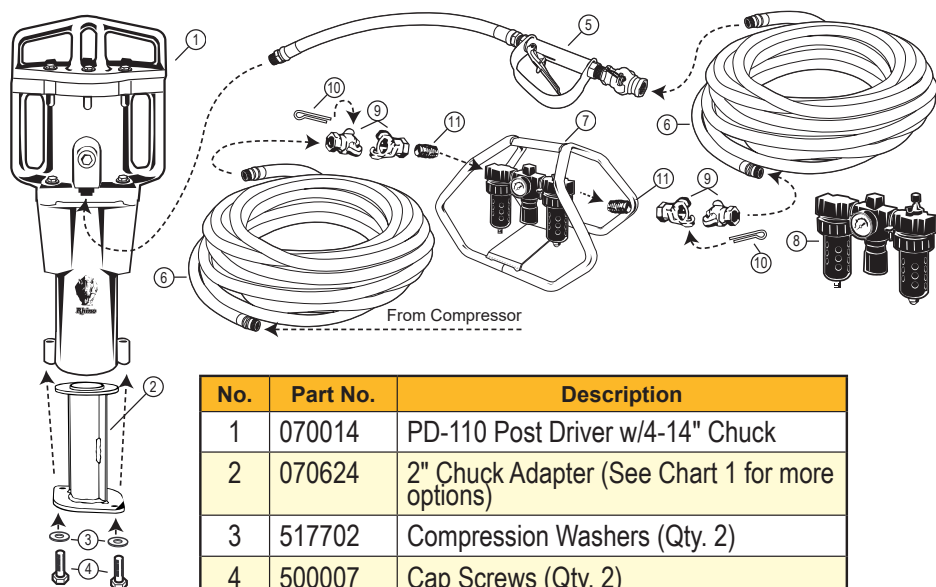

No.	Part No.	Description
1	070014	PD-110 Post Driver w/4-14" Chuck
2	070624	2" Chuck Adapter (See Chart 1 for more options)
3	517702	Compression Washers (Qty. 2)
4	500007	Cap Screws (Qty. 2)
5	600000	Throttle Valve Kit with 5 ft. Hose
6	607000	Hose Assembly*
7	225001	Carrier for FRL
8	601128	Filter-Regulator-Lubricator
9	606600	Air Line Coupler
10	606601	Coupler Safety Clip (limit 4 per order)
11	230401	3/4" Close Nipple

*\*Made to order at desired length - additional charge per foot of hose*

Chuck adapters and part numbers. 3" and 3.5" Drive Cap Required for driving 3" and 3.5" Schedule 40 Pipe. See Chart 1 for size information.



**Chart 1** - Master chuck and chuck adapter sizes and part numbers.

PD-110 Adapters*/Drive Caps	
Description/Actual ID-in (mm)	Part No.
4-1/4" (107.9) Master Chuck	070593
3-5/8" (92)	070622
3" (76.2)	070623
2-1/2" (63.5)	070624
2" (50.8)	070625
1 to 1-1/2 lbs/ft Channel Post	070628
2 to 2.75 lbs/ft Channel Post	070629
3 to 4 lbs/ft Channel Post	070630
4-3/4" Master Chuck	070644
3" Drive Cap, T-bar and Clip	071262
3-1/2" Drive Cap, T-bar and Clip	071263

*\*All adapters come with required hardware*



**A Tradition of Quality and Service Since 1975**